



# SC101T

## Storage Central Turbo

- *Help is there when you need it! NETGEAR provides 24x7 technical support\* in English, with selected local language support during office hours.*

### Fail-safe, Affordable, Shareable, Turbo Gigabit Speed

- Access your storage at gigabit speeds
- Network storage appears as a letter drive on your PCs
- Disk Mirroring ensures valuable data will not be lost
- Continue to upgrade your storage capacity easily
- Advanced backup and synchronization software from SmartSync™ is included

**Fail-Safe Network Storage** ● NETGEAR's Storage Central Turbo is the only fail-safe, upgradeable way to store your music, photos and videos—and access them at gigabit speeds. Simply insert one or two 3.5-inch SATA drives of any capacity from any vendor (sold separately) into Storage Central Turbo, connect it to any router or switch, and Smart Wizard takes care of the configuration. It functions just like a local disk drive, accessible from any network computer, but without requiring a dedicated PC. Advanced backup and synchronization software protects against data loss automatically with mirroring. And as your storage needs grow, Storage Central Turbo keeps pace by letting you upgrade with larger capacity SATA drives—and even additional Storage Central Turbo devices.

- Easy** ●
- **Set Up**—Just slide in one or two 3.5" Serial ATA (SATA) disk drives of any capacity.
  - **Installation**—Connect Storage Central to any router or switch, then configure with Smart Wizard™.
  - **Sharing**—Access files from any PC on your network by installing the utility; Storage Central functions like a local disk drive.

- Safe** ●
- **Data**—Automatically duplicates your valuable files.
  - **Advanced backup** and synchronization software from SmartSync included.
  - **Privacy**—Ensures no one can access your sensitive files but you.

- Powerful** ●
- **Mirrored volumes**—Makes real-time copies of your valuable data on two separate hard drives, ensuring maximum protection against data loss.
  - **Move files**—Enjoy gigabit speeds to move the largest files quickly.
  - **Infinite capacity**—Storage can be expanded indefinitely, keeping pace with all of your future storage needs.

### Storage Central Turbo: Your Network's Virtual Warehouse

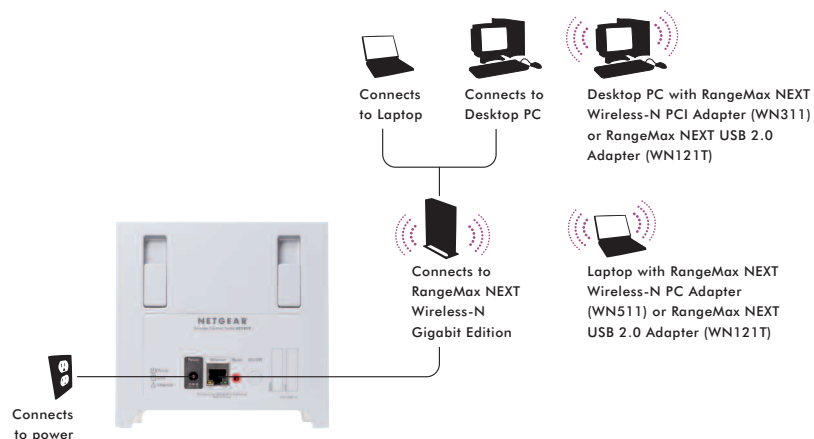

Side-by-Side Comparison of Storage Products

Features	USB External Disk Drive	Single-Drive NAS <sup>1</sup>	Storage Central (SC101T)
Connects to the home router		●	●
Embedded mirror/data protection			●
Expands capacity of your storage volume			●
Appears as local disk/drive letter	●		●
Hides private drive from others			●
Shareable without dedicated PC		●	●
Uses any SATA drive from any vendor			●
Includes backup software			●

<sup>1</sup>Such as Maxtor Shared Storage, Iomega NAS 100d, Linksys NSLU2, Mirra Personal Server, Buffalo LinkStation

The Most Flexible and Upgradeable Device with the Lowest Price

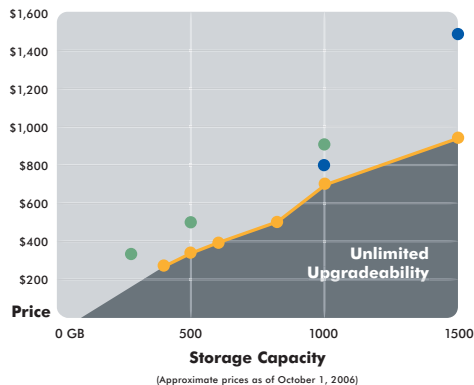

● NETGEAR Storage Central Turbo ● Maxtor Shared Storage ● Buffalo Terastation

Turbocharged Gigabit Speed Minutes to Transfer

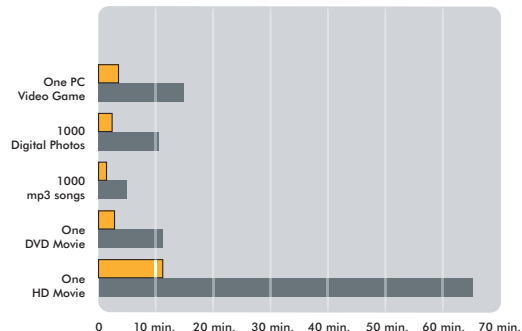

● NETGEAR Storage Central Turbo (SC101T) ● Typical 100 Mbps NAS device



4500 Great America Parkway  
 Santa Clara, CA 95054 USA  
 Phone: 1-888-NETGEAR (638-4327)  
 E-mail: info@NETGEAR.com  
 www.NETGEAR.com

©2006 NETGEAR, Inc., NETGEAR, the Netgear logo, Connect with Innovation, Everybody's connecting, the Gear Guy logo, IntelliFi, ProSafe, RangeMax and Smart Wizard are trademarks of NETGEAR, Inc. in the United States and/or other countries. Microsoft, Windows and the Windows logo are trademarks of Microsoft Corporation in the United States and/or other countries. Zeterra and the Zeterra logo are registered trademarks of Zeterra Corporation. Data Flow and the DataFlow logo are registered trademarks of DataFlow, Incorporated. Other brand and product names are trademarks or registered trademarks of their respective holders. Information is subject to change without notice. All rights reserved.

\* Free basic installation support provided for 90 days from date of purchase. Advanced product features and configurations are not included in free basic installation support; optional premium support available.

\*\*Actual performance may vary due to operating conditions

System Requirements

- Microsoft® Windows® 2000 (SP4), XP Home or Pro (SP1 or SP2)
- DHCP server in the network
- Compatible with Serial ATA (SATA) hard disks

Interface

- 10/100/1000 Mbps (auto-sensing) Ethernet, RJ-45

Standards

- IEEE 802.3, IEEE 802.3u, IEEE 802.3ab

Supported Protocol

- TCP/IP, DHCP, SAN

Controls

- One Power ON/OFF switch
- One Reset Button

Connection Speed

- 10/100/1000 Mbps

Supported Hard Drives

- Two 3.5" Serial ATA (SATA) hard drives

Diagnostic LEDs

- Power: Green
- Hard Disk: Blue
- Network: Green

Physical Specifications

- Dimensions: 6.90 x 5.91 x 5.74 in (175.25 x 150 x 146 mm) (L x W x H)
- Ambient Operating Temperature: 0-95° F (0-35° C)

- Certifications: FCC, CE, IC, C-Tick

Package Contents

- Storage Central Turbo (SC101T)
- 12V, 7.0A Power Adapter, localized to country of sale
- Ethernet Cable
- Installation Guide
- Setup CD
- SmartSync™ Pro Backup Software CD
- Warranty/Support Information Card

Warranty

- NETGEAR 1-year warranty (see information enclosed)

NETGEAR Related Products

Wireless

- RangeMax **NEXT** Wireless-N Router (WNR834B or WNR834M)
- RangeMax™ Router (WPN824)
- 108 Mbps Firewall Router (WGT624)
- 54 Mbps Router (WGR614)

Wired

- Wall-Plugged Ethernet Bridge (XE102)
- 85 Mbps Wall-Plugged Ethernet Bridge w/ 4 port Switch (XE104)
- Powerline HD Ethernet Adapter (HDX101)